

Trennung Mitte

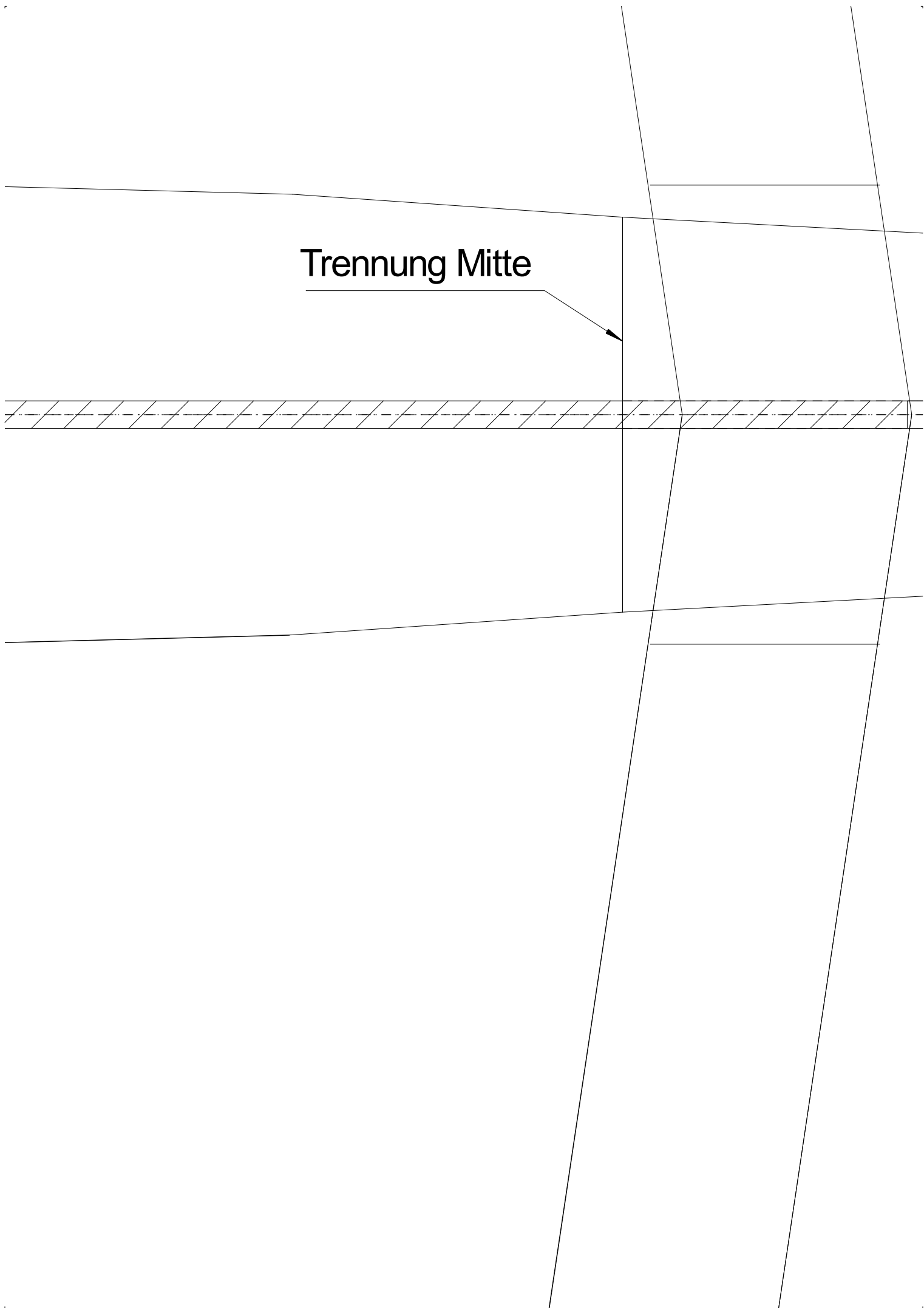



The image shows a technical drawing of a tapered shaft. The shaft is represented by two parallel lines that converge towards the right. A horizontal section line is drawn across the shaft, with a hatched area on the right side. The hatching consists of diagonal lines sloping downwards from left to right. The text below the drawing reads: "Alle schraffierten Flächen" and "Cut all hatched areas!".

Alle schraffierten Flächen
Cut all hatched areas!

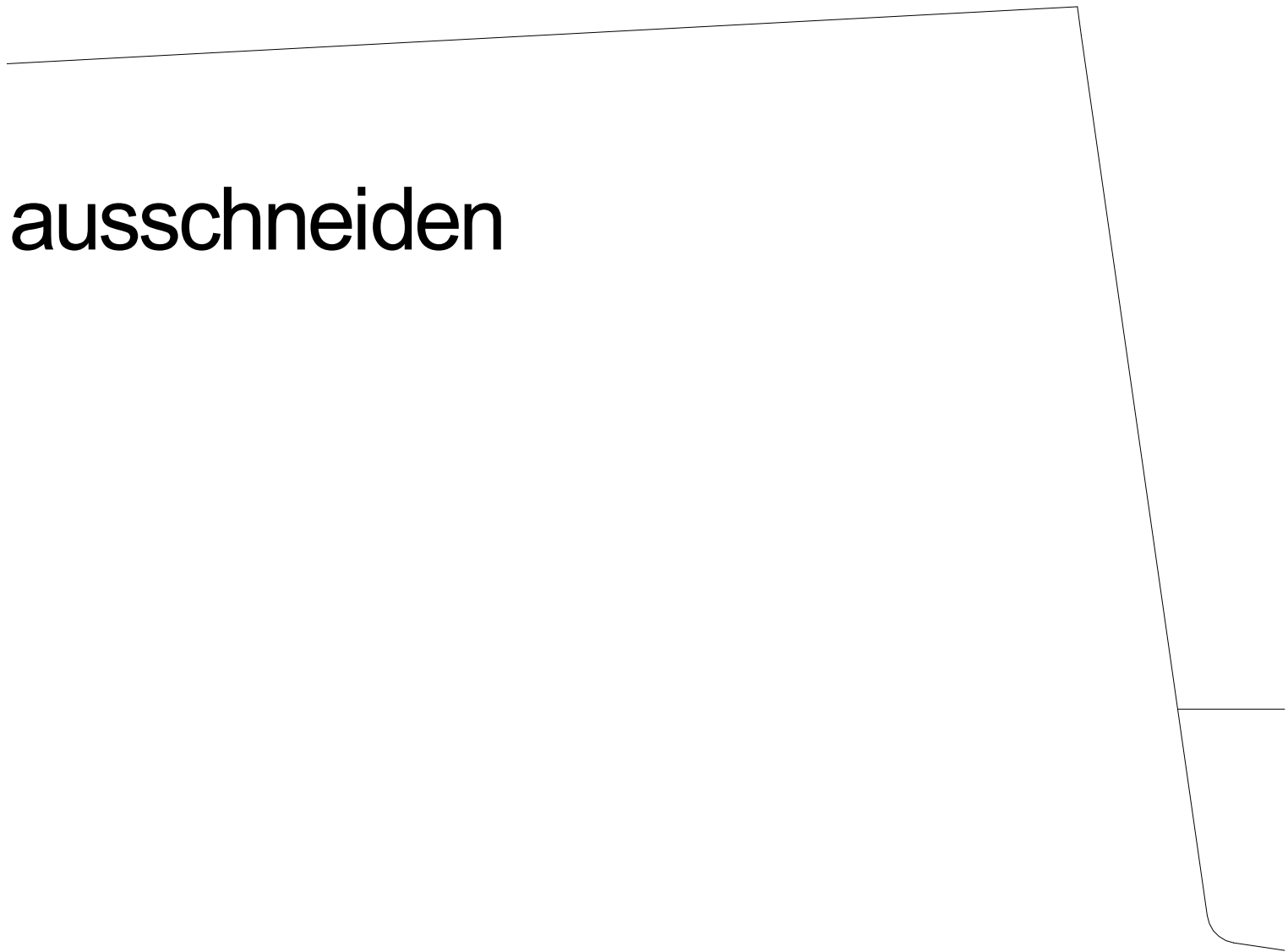
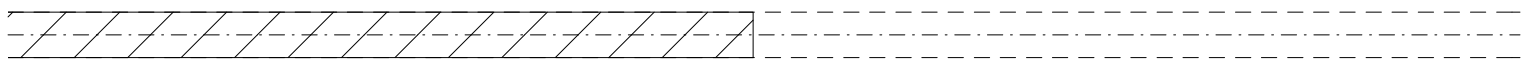

ausschneiden

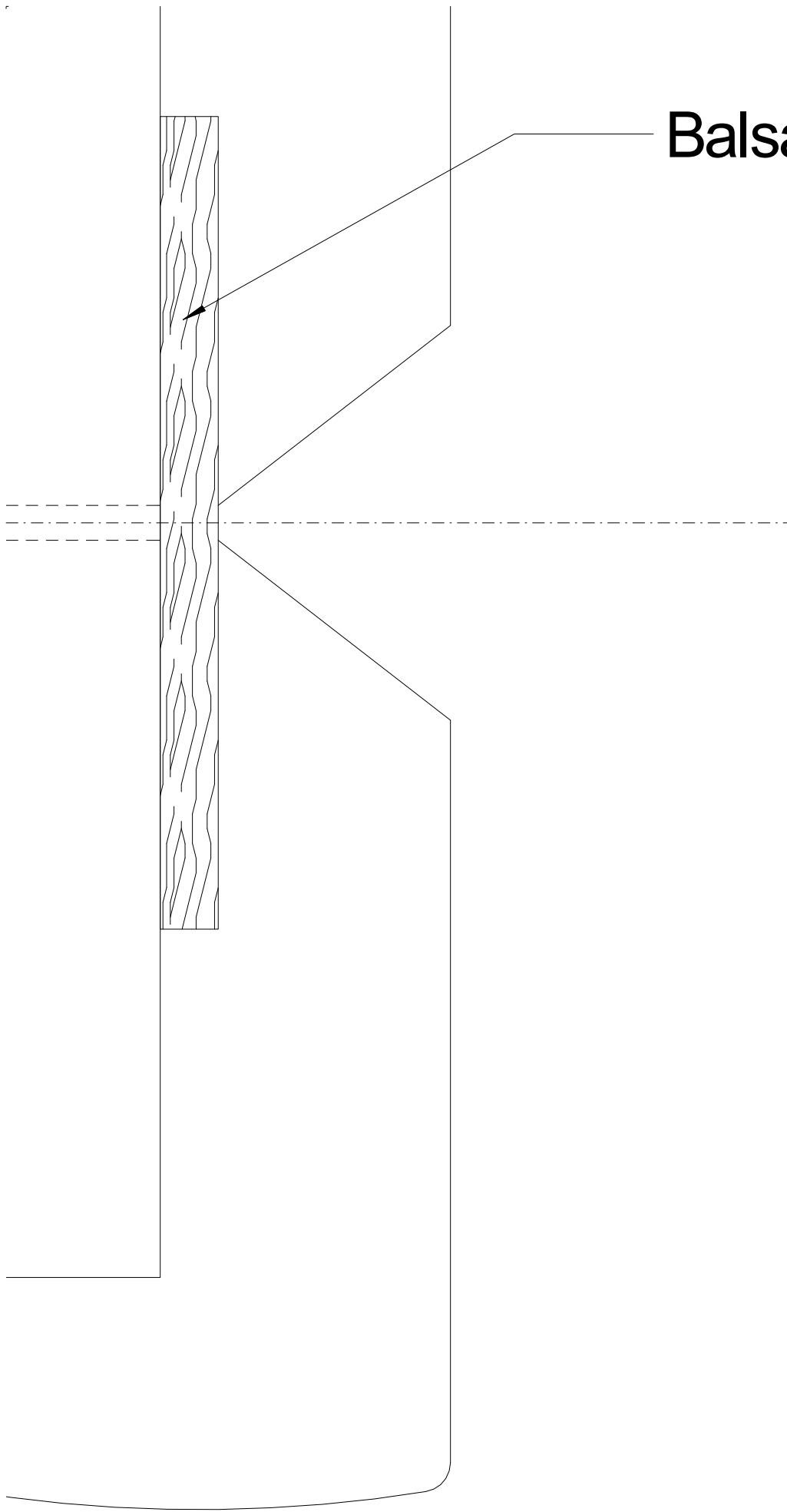

Balsa 6mm

FV

Keine g
ohne s
No cor
written
Copyri
Wolfra
www.v

Alle
All d

28.1

V-190 D9

gewerbliche Nutzung
chriftliche Zustimmung
nmercial use without
permission !
ght (c) 2004 by
m Herzog
vherzog.de/eflug

Maße in Millimetern
imensions in millimeters

DEZ.2004 Version 1.1

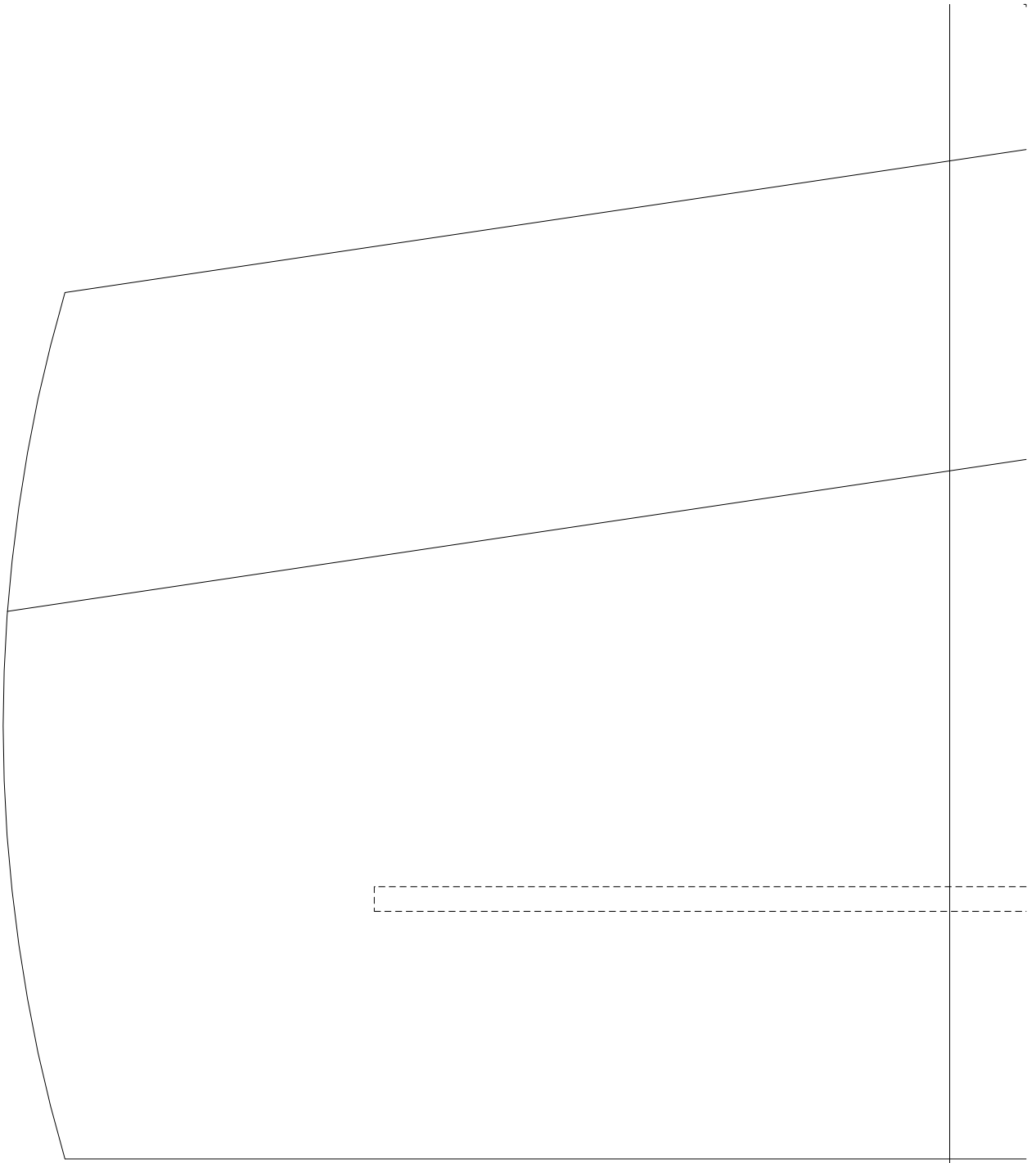

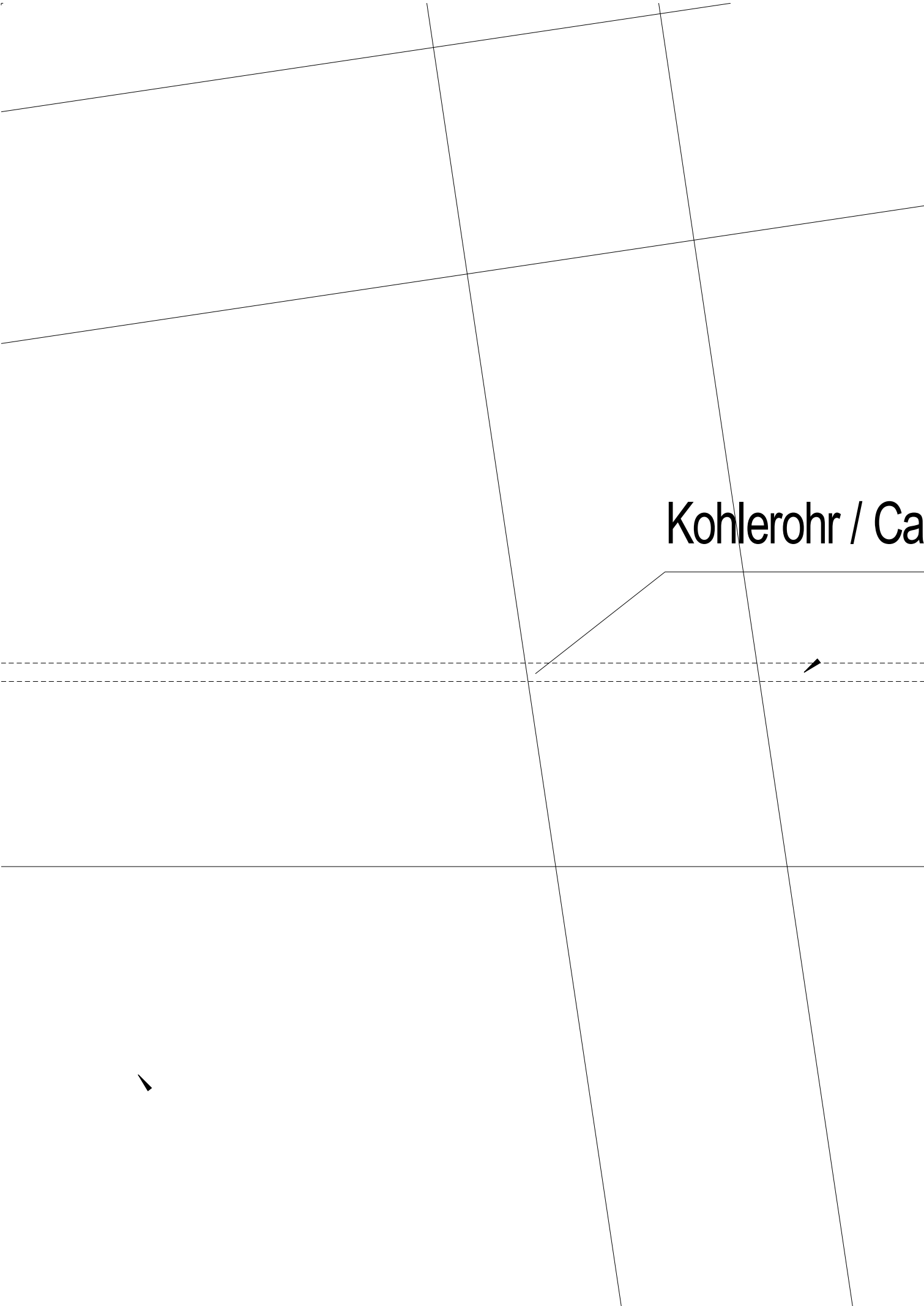

Kohlerrohr / Ca

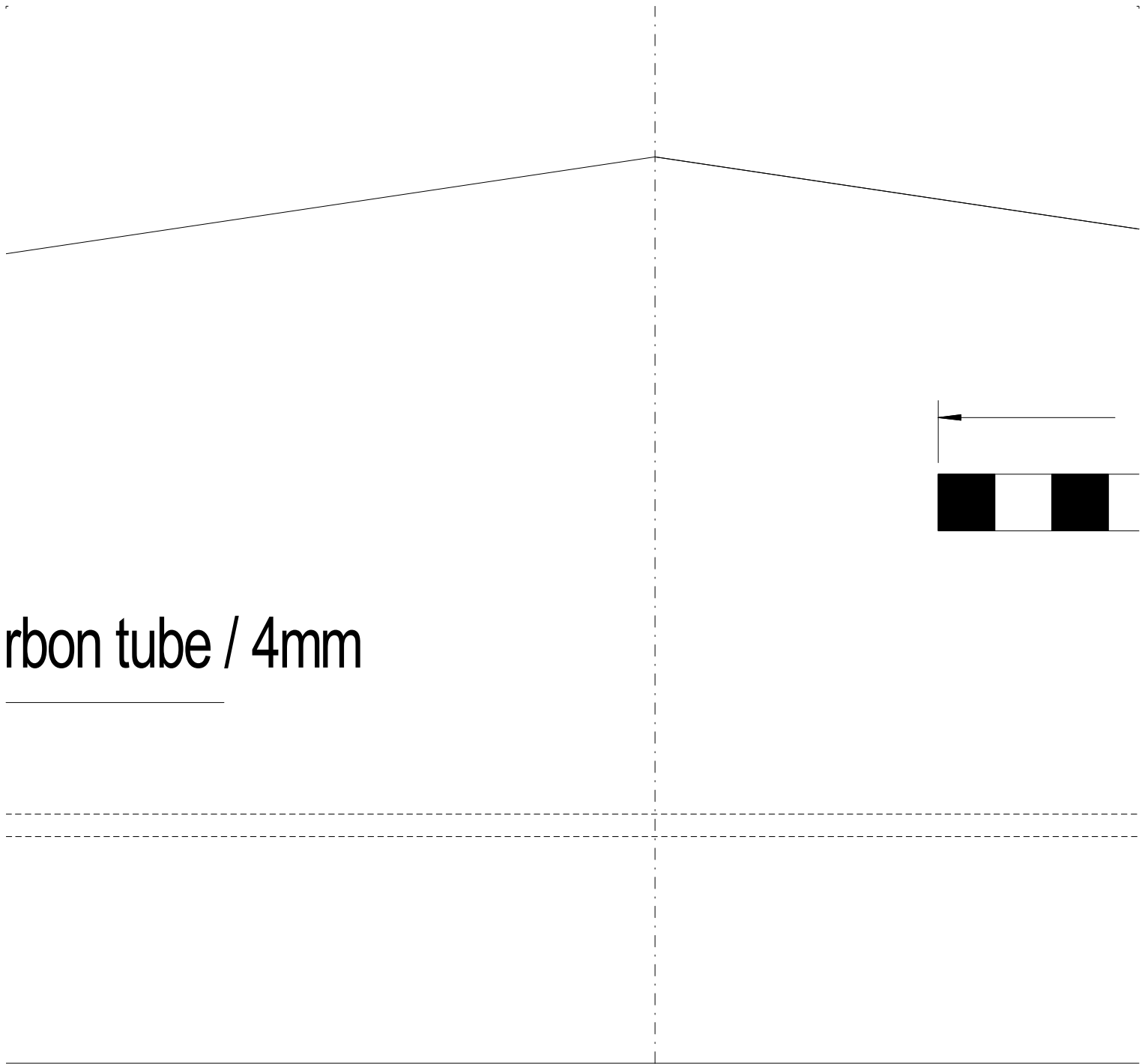

Carbon tube / 4mm

Alle Teile aus 6mm Depron
All parts 6mm Depron (white)

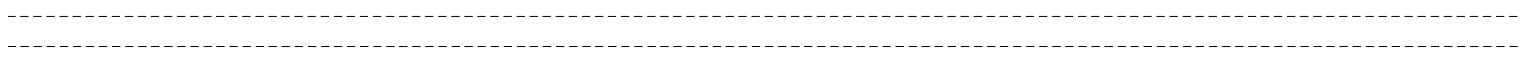
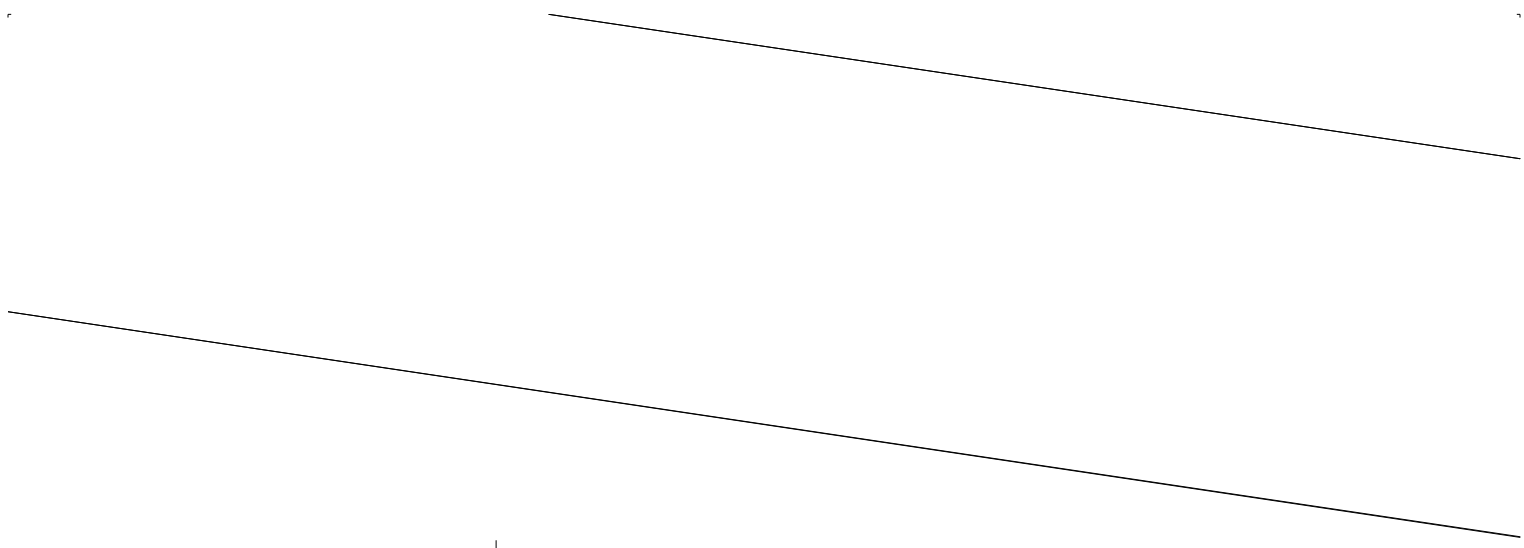

r weiß
te)

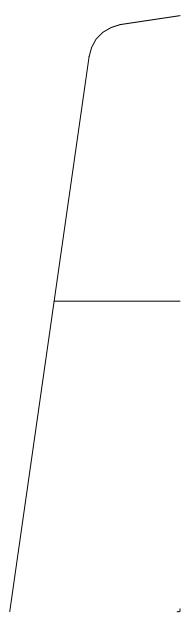

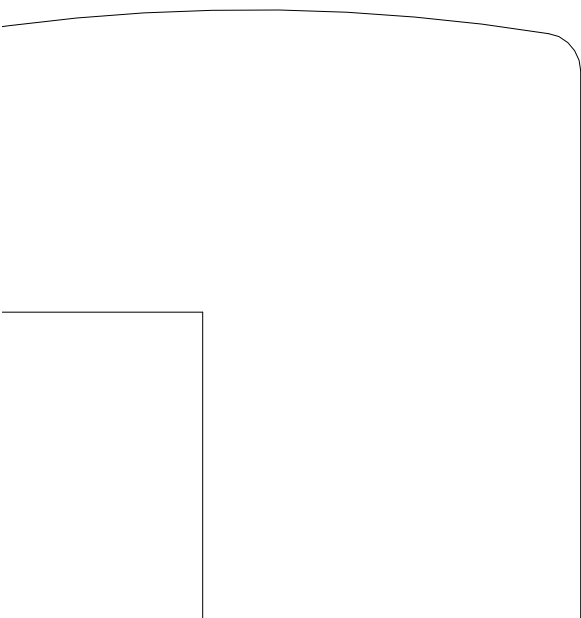
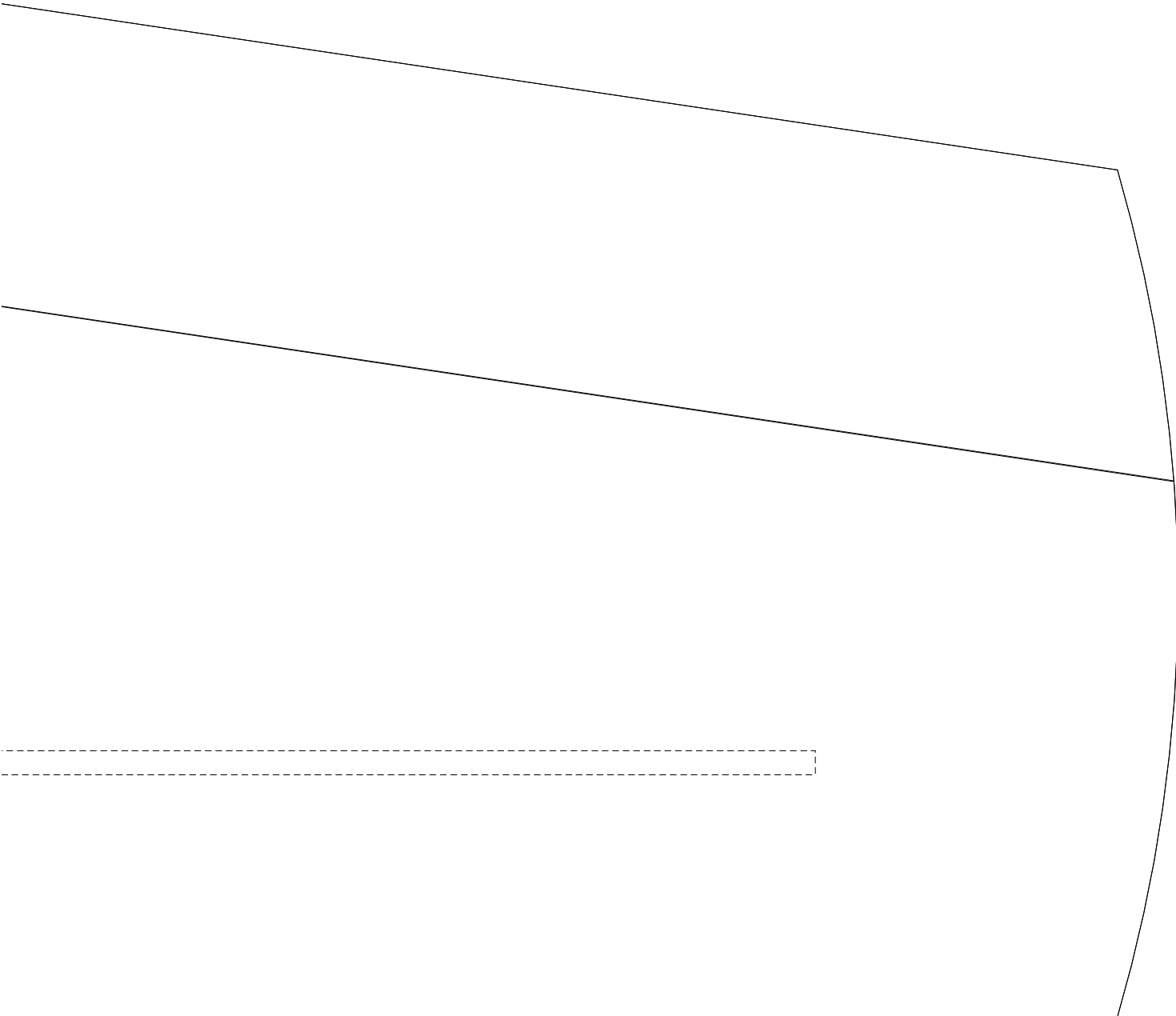

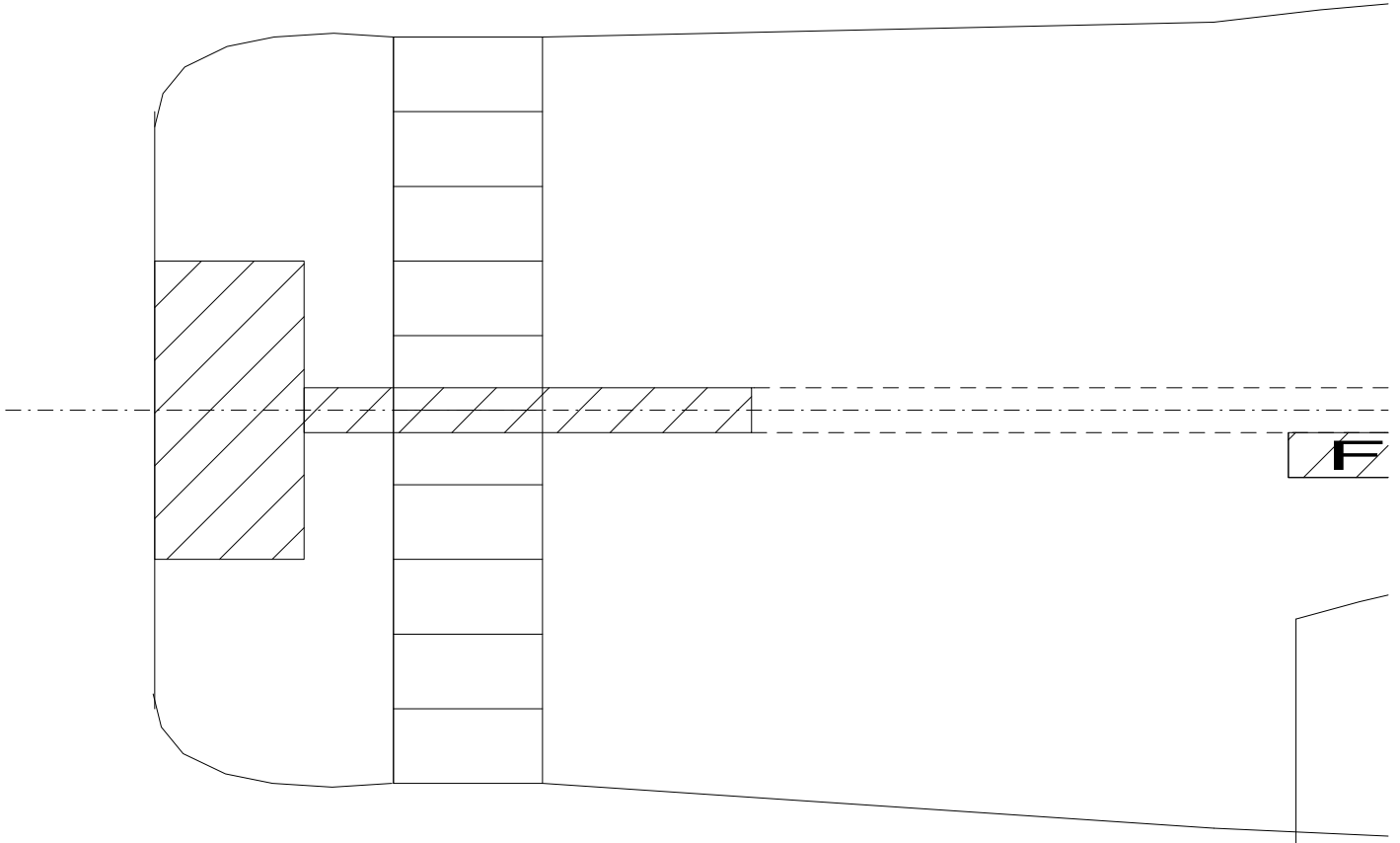

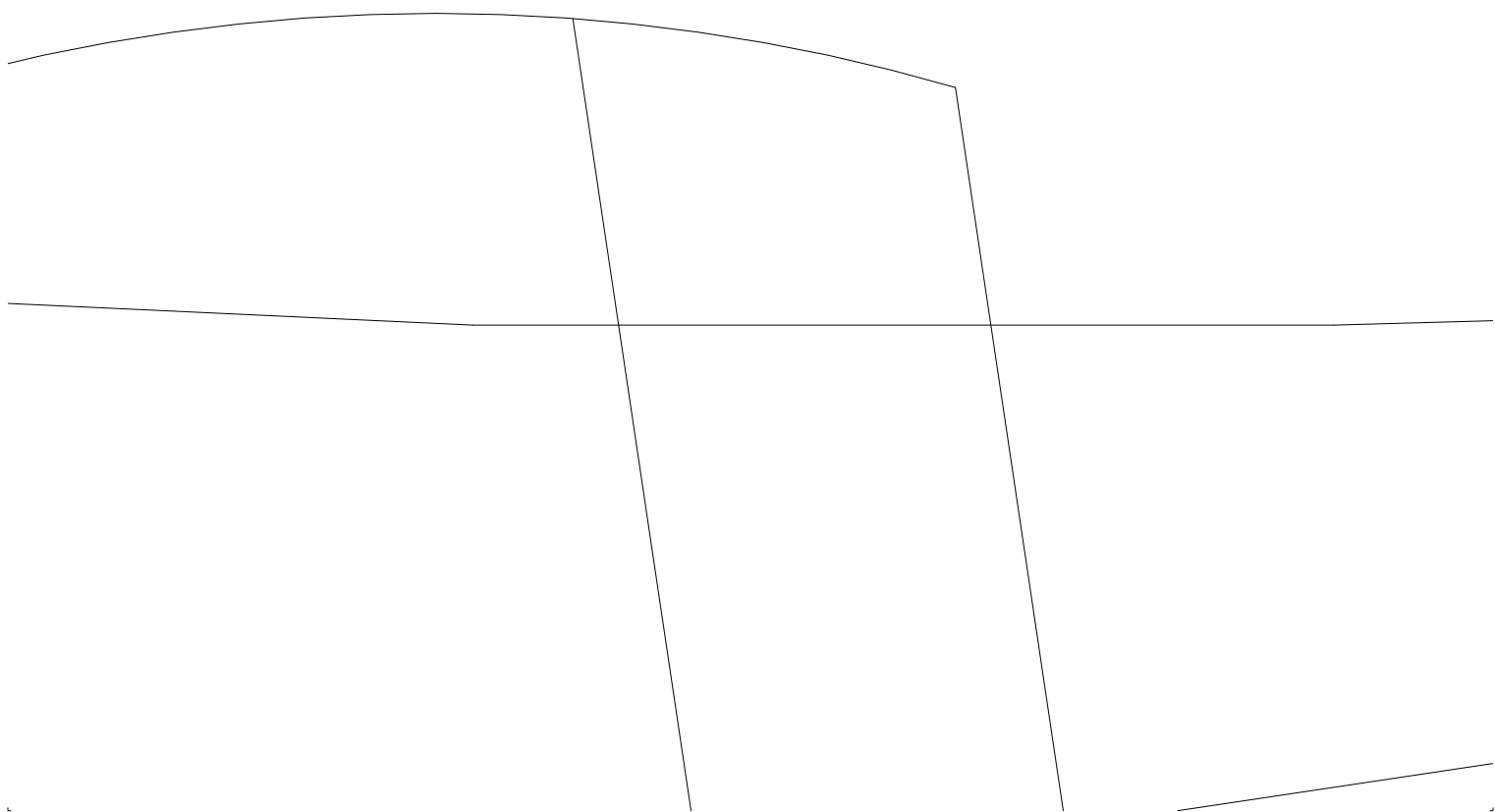
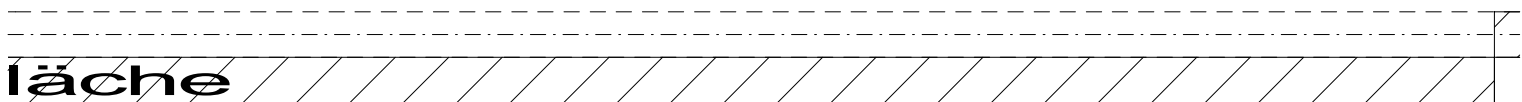

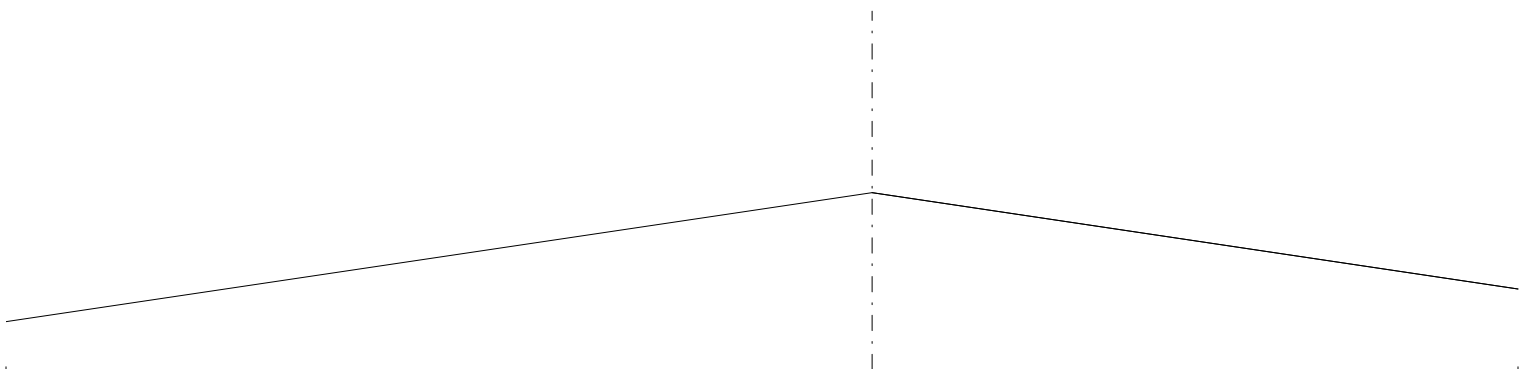
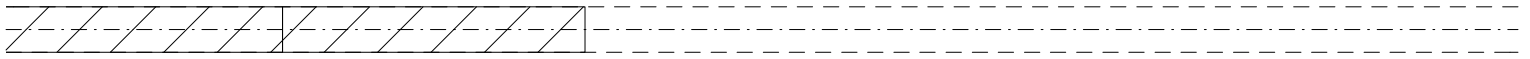
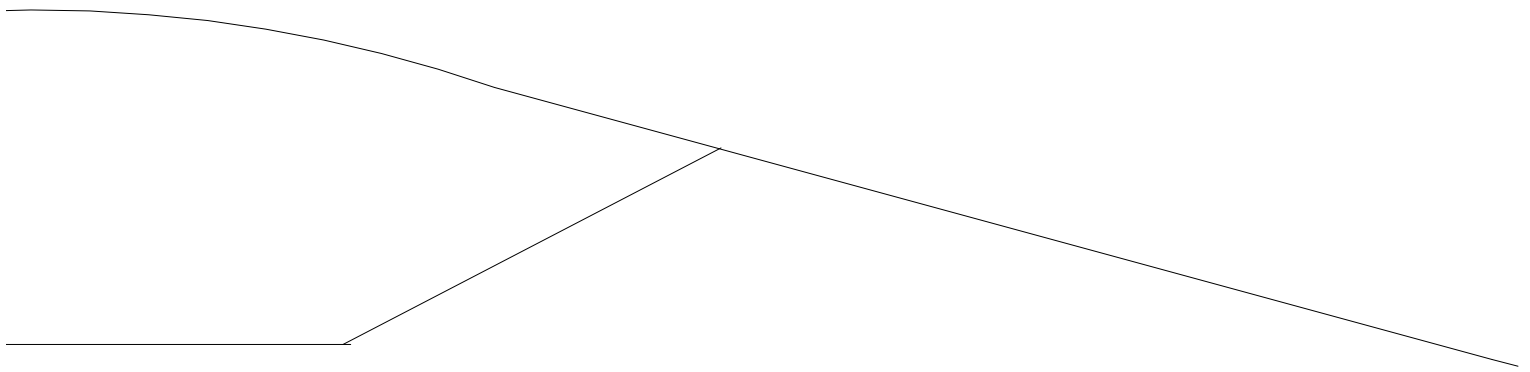

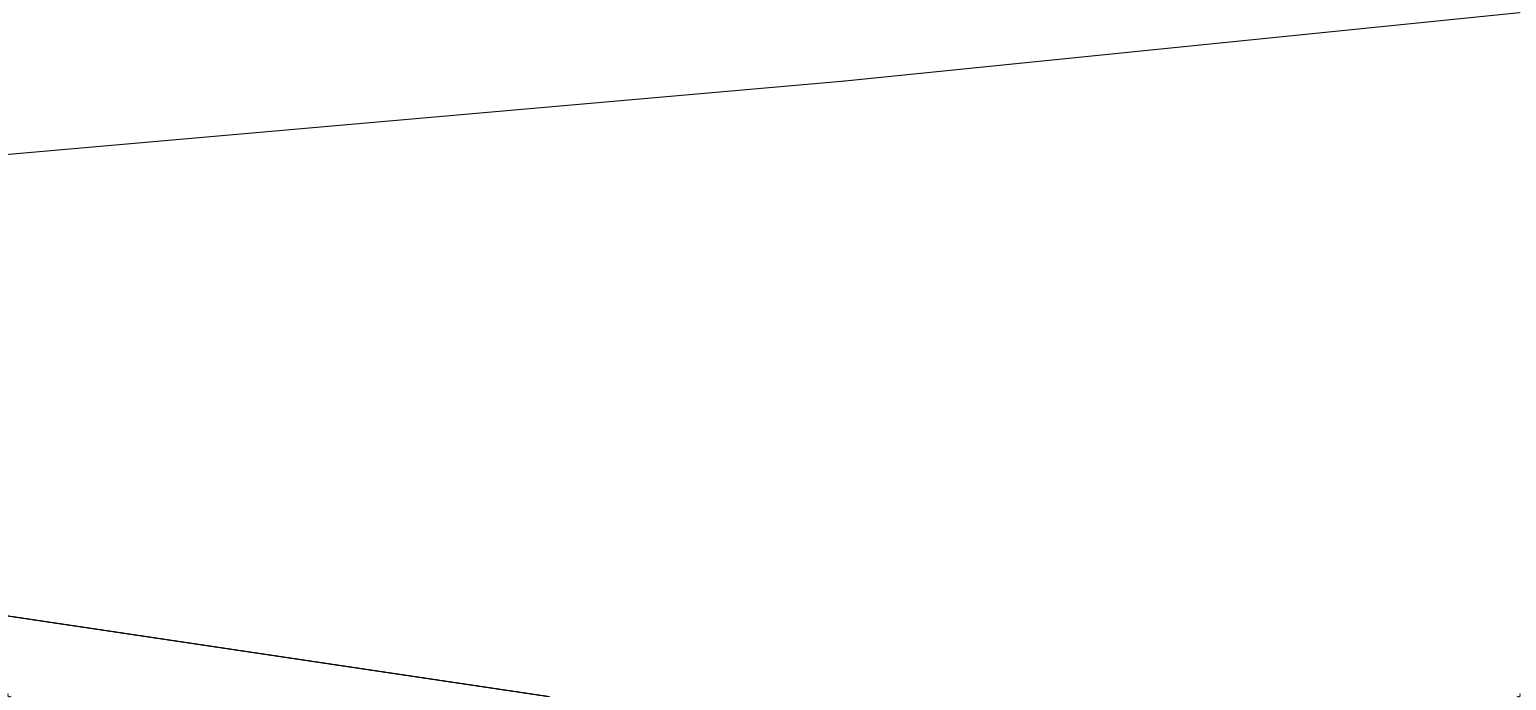
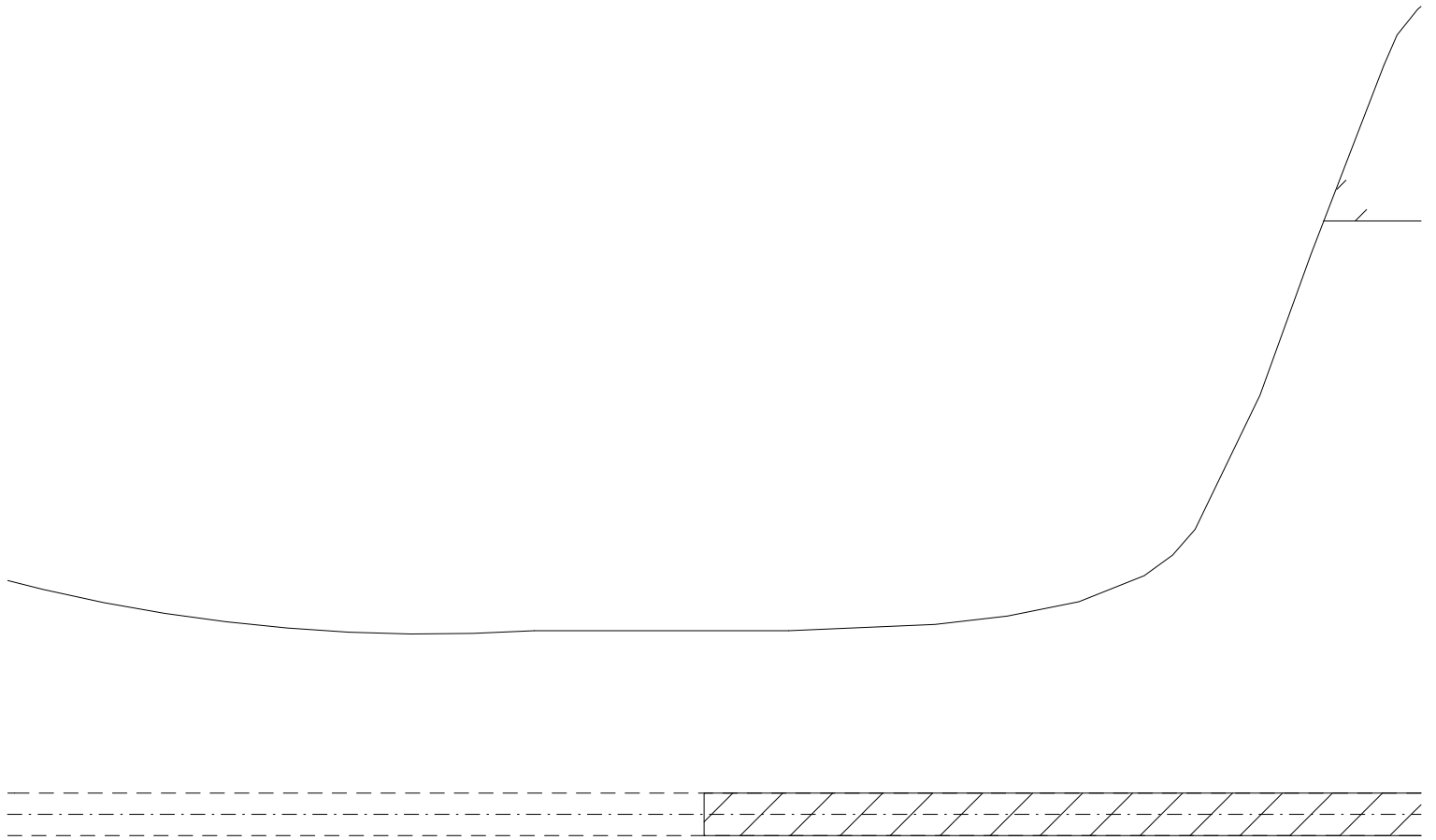

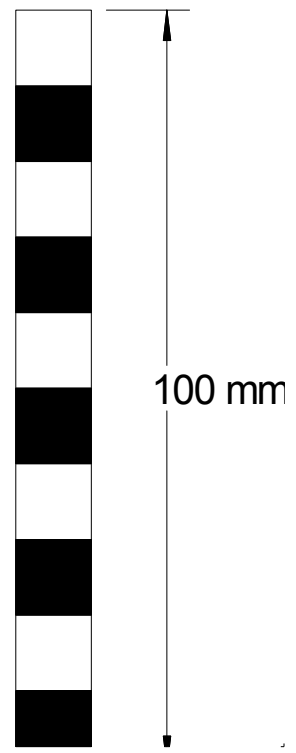
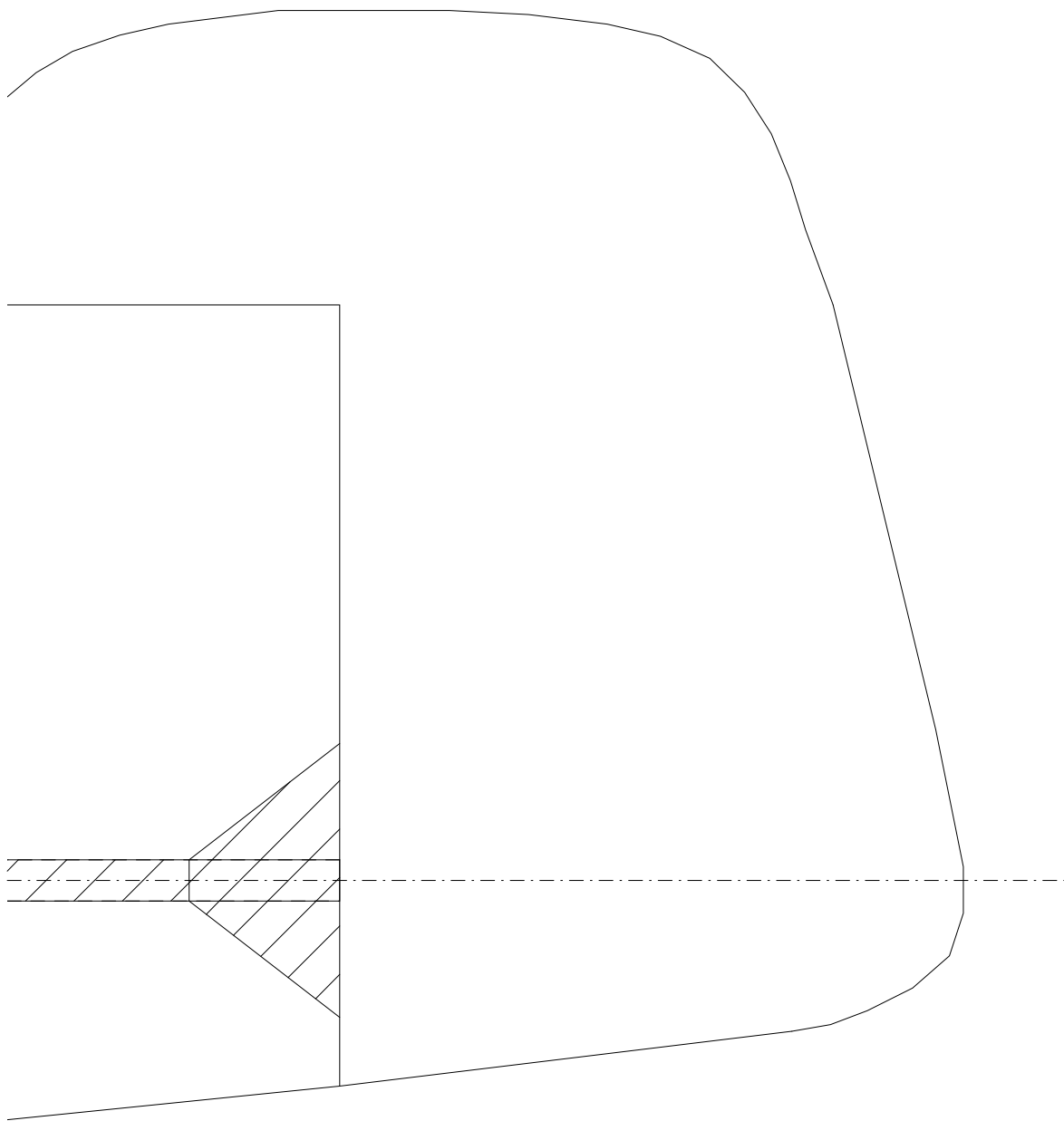

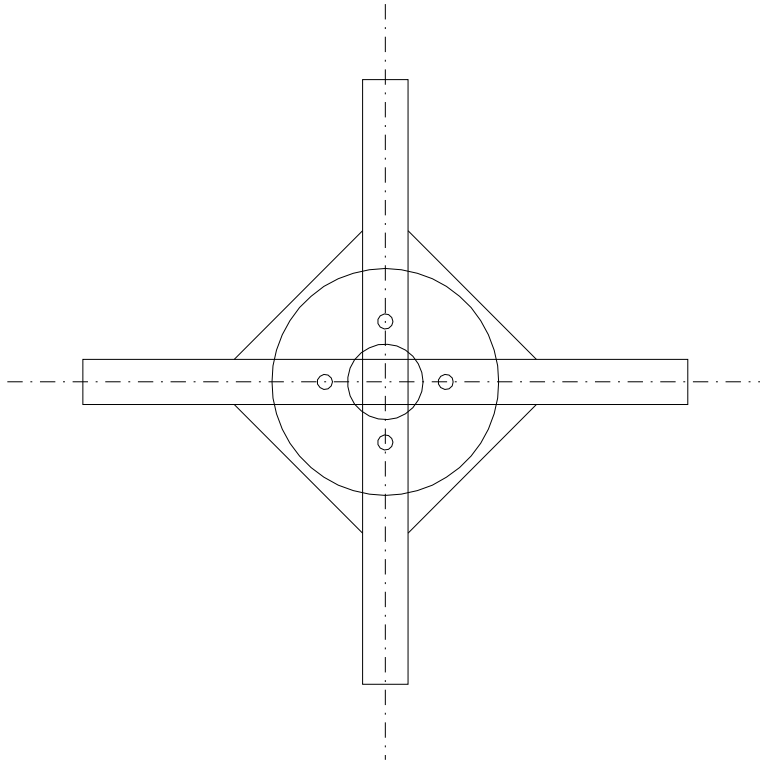

Motorspant Engine mount